

# LP1 LOW PRESSURE LOWER MOUNT



**Capsule type pressure gauge for accurate measurement of low pressures  
Suitable for air, water, oil, gas or any other media not corrosive to copper alloy**

## SPECIFICATIONS

<b>Dial</b>	2 ½" (63 mm)
<b>Case</b>	Chrome plated steel, dry non-fillable
<b>Wetted Parts</b>	Copper alloy
<b>Lens</b>	Plastic, removable twist lock
<b>Pointer</b>	Adjustable, black aluminum Adjustment screw at rear of case
<b>Connection</b>	Lower mount ¼" NPT
<b>Scale</b>	Standard: single scale inches of water column or psi
<b>Accuracy</b>	3-2-3% of span, ASME B40.1 Grade B
<b>Ambient Temp</b>	-30° F to 180° F

*Design meets or exceeds ASME B40.100 pressure gauge standard.*

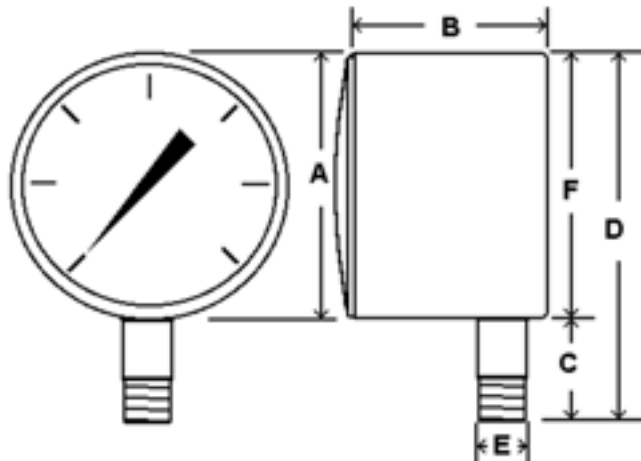

Dial	Unit	A	B	C	D	E	F
2 ½"	In.	2.62"	1.85"	.85"	3.45"	¼"	2.6"
	mm	67	47	22	88	NPT	66

## AVAILABLE OPTIONS\*

- Certificate of Accuracy, NIST Traceable
- Custom Dial
- Special Connection Size
- Cleaned for Oxygen Service
- Protective Rubber Cover, see page 121
- Dual Scale

\*Lead times/minimums may apply

## APPROXIMATE SHIPPING WEIGHTS/ BOX QUANTITIES

Dial Size	Est. Unit Wt.	Box Qty
2 ½"	0.50 lbs (0.24 kg)	100

5